

# Black Forest Map Rally

## Saturday, June 27, 11:00 a.m.

Join us for the annual map rally. Each driver will have a different set of maps to follow—each map leading to the next—until all drivers wind up in the same place to have lunch together. Be sure you have a passenger or groom to retrieve the maps and share the day with you.

Bring a picnic lunch as well as water for your horse. Don't forget fly repellent, sun screen, and rain gear "just in case." For more information, contact Vickroy at (303) 814-9936.

### Directions to the event:

From the north:

Take I-25 south to the Monument exit. Go east on Hwy 105 about 5 miles. Turn south/right on Hwy 83. Go about 2 miles and turn east/left onto Hodgen Rd. (Alternatively, Take I-25 south to exit 158, Baptist Rd. east. Baptist Rd. will turn into Hodgen Rd. just before Hodgen & Hwy 105 intersect.) Go about 3 miles and turn south/right onto Black Forest Rd. Go about 6 miles and turn east/left onto Tobin Rd. Park at the corner of Tobin Rd. and Egerton (about 1/2 mile).

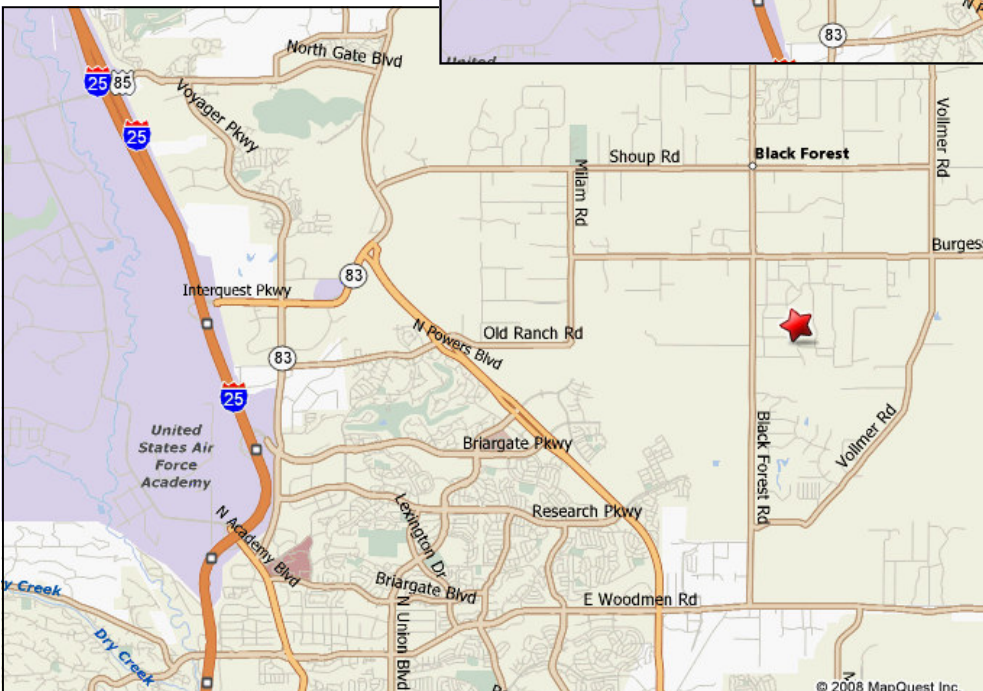
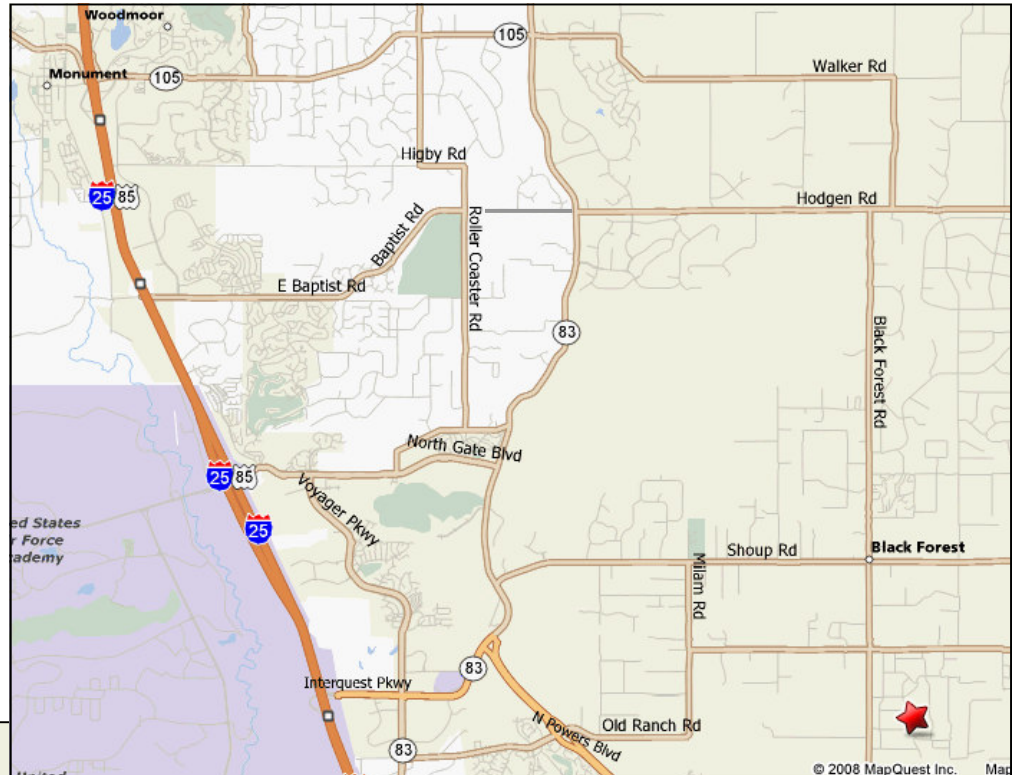

From the south:

Take I-25 north to Woodmen Rd. Go east on Woodmen Rd. about 7 miles. Turn north/left on Black Forest Rd. Go about 3 miles to Tobin Rd. Turn east/right onto Tobin Rd. Park at the corner of Tobin Rd. and Egerton (about 1/2 mile).